

# MYZEK®

## PRO-SPRAY

ELECTRIC PAINT SPRAYER  
MYESG01



User Manual - Please read and retain for future reference

[www.hygienesuppliesdirect.com](http://www.hygienesuppliesdirect.com)

# Contents

|  | PAGE  |
|--|-------|
| Safety instructions for MYESG01 .....                          | 3     |
| Technical data MYESG01.....                                    | 6     |
| Explanation of the system.....                                 | 7     |
| Functional description .....                                   | 7     |
| Materials which can be used.....                               | 7     |
| Materials which cannot be used .....                           | 7     |
| Explanatory diagram MYESG01.....                               | 8     |
| Preparation of the coating material .....                      | 8     |
| Measuring the viscosity with the viscosity measuring cup ..... | 9     |
| Viscosity table.....   | 9     |
| Starting up.....   | 10-11 |
| Adjusting the spray gun .....                                  | 11    |
| Choice of spraying effects .....                               | 12    |
| Adjusting the required spray effect.....                       | 12    |
| Adjusting the amount of material .....                         | 12    |
| Spraying technique.....  | 12-13 |
| Closing down and cleaning .....                                | 13-14 |
| Changing the washable air filter.....                          | 14    |
| Troubleshooting .....  | 15    |
| Environmental Responsibilities .....                           | 16    |
| Customer Service.....  | 16    |

## Safety instructions for MYESG01:



- Please read the operating instructions thoroughly and observe the safety instructions
- Only coating materials such as paints, enamels, varnishes, etc, with a flash point of 32°C and above may be sprayed.
- The device may not be based in work places which are covered by the explosion protection regulations.
- When spraying, ensure that there are no sources of ignition, e.g. open fire, cigarettes, cigars, and pipes, sparks, glowing wires, hot surfaces, etc, in the area.
- When working with the device MYESG01 inside and outside care must be taken that no solvent vapours are sucked into the device.
- When outdoors observe wind direction. When working indoors ensure that there is sufficient ventilation.
- Do not spray at the device.
- The device is only splash-proof when the air hose is correctly connected.
- Do not let children play with the device. Keep out of reach of children. This is NOT a toy.
- Care must be taken not to damage the cable. If the cable is damaged take it immediately to an authorised customer service centre to be changed.
- Remove mains plug from socket when not in use.
- Repairs to electrical parts should only be carried out at an authorised customer service centre.
- Do not use spray guns to spray flammable liquids.
- Do not clean spray guns with flammable solvents.
- Take precautionary measures against potential hazards from spray liquids and follow any instructions given on containers or laid down by the manufacturer of liquid.
- Do not spray any liquids of unknown hazard potential.
- Keep work area clean and well illuminated.
- Do not operate the paint sprayer in an explosive atmosphere, such as in the presence of flammable liquids, gases or dust.

- Keep children and bystanders away while operating the paint sprayer.
- The paint sprayer plug must match the outlet. Never modify the plug in any way. Do not use with any adaptor plugs.
- Avoid body contact with earthed or grounded surfaces such as pipes, radiators, ranges and refrigerators.
- Do not expose the paint sprayer to rain or wet conditions.
- Do not abuse the cord. Never use the cord for carrying or pulling the paint sprayer. Keep cord away from heat, oil, sharp edges or moving parts.
- When operating the paint sprayer outdoors, use an extension cord suitable for outdoor use.
- Stay alert, watch what you are doing and use common sense when operating a paint sprayer. Do not use a paint sprayer while you are tired or under the influence of drugs, alcohol or medication.
- Use safety equipment. Always wear eye protection.
- Avoid accidental starting. Ensure the power switch is in the off position before plugging in.
- Do not overreach. Keep proper footing and balance at all times.
- Dress properly. Do not wear loose clothing or jewellery. Keep your hair, clothing and gloves away from moving parts.
- If devices are provided for the connection of dust extraction and collection facilities, ensure these are connected and properly used.
- Do not use the paint sprayer if the power switch is faulty.
- Disconnect the plug from the power source before making any adjustments to the spray nozzle, changing accessories, or storing power tools.
- Store the paint sprayer out of the reach of children and do not allow persons unfamiliar with the paint sprayer or these instructions to operate the paint sprayer.
- Maintain the paint sprayer. Check for misalignment or binding of moving parts, breakage of parts and any other condition that may affect the paint sprayers operation. If damaged, have the paint sprayer repaired before use.
- Use the paint sprayer, in accordance with these instructions and in the manner of it's intended purpose, taking into account the working conditions and the work to be performed

- Recommendation: wear breathing protection when spraying.
- CAUTION: DANGER OF INJURY!  
Never point the spray gun at yourself or other persons or animals.
- CAUTION: Never point or spray the gun directly at the unit.

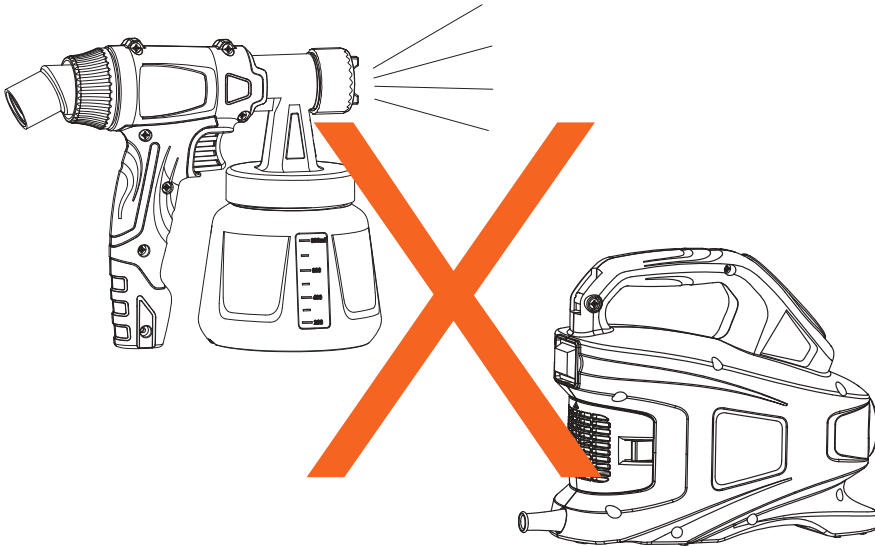

## Technical data MYESG01:

|                         |   |
|-------------------------|---|
| Max. viscosity:         | 60DIN-s   |
| Voltage:                | 220-240VAC 50Hz   |
| Power consumption:      | 700W  |
| Max. back air pressure: | 0.1-0.3bar  |
| Double insulation:      |  |
| Mains cable:            | 2m  |
| Sound pressure level:   | 79.2 dB(A)  |
| Oscillation level:      | 0.154m/s <sup>2</sup>   |
| Air hose length:        | 1.8m  |
| Container capacity:     | 900ml/1200ml  |
| Nozzle size:            | 2.5mm   |
| Weight:                 | 2.5kg   |

## What's in the Box:

- 1 x Spray Gun
- 1 x 1.8m Hose
- 1 x Motor Unit
- 2 x paint cups
- 1 x spare filter
- 1 x cleaning needle
- 1 x shoulder strap
- 1 x viscosity measuring cup

## Explanation of the system:

The device operates at low pressure. A high volume of air surrounds the spray jet being ejected under low pressure. The air cap provides a very fine atomisation with the lowest of spray mist. The coating material is applied to the object quickly and evenly. Moreover, the air flow shortens the drying time for the coating material. This gives perfect spraying results with a respective saving of coating material and is therefore good for the environment.

## Function description:

The motor blower produces a flow of air which flows through the air hose to the spray gun. The air flow atomises the coating material at the nozzle and also pressurises the container. This pressure pushes the coating material up the ascending pipe to the nozzle. The air and pressure setting can be adjusted progressively.

## Materials which can be used:

Oil and water-based paints, enamel paints, sealers, latex, varnishes, primers, two-component paints, clear enamels, wood preservatives, decking, sheds and fence stains. Always read the manufacturers label which will state if it is suitable for use in a spray gun.

## Materials which cannot be used:

Textured wall paints and acid containing coating materials. If the manufacturer's instructions say 'brush application only' then the material probably cannot be sprayed.



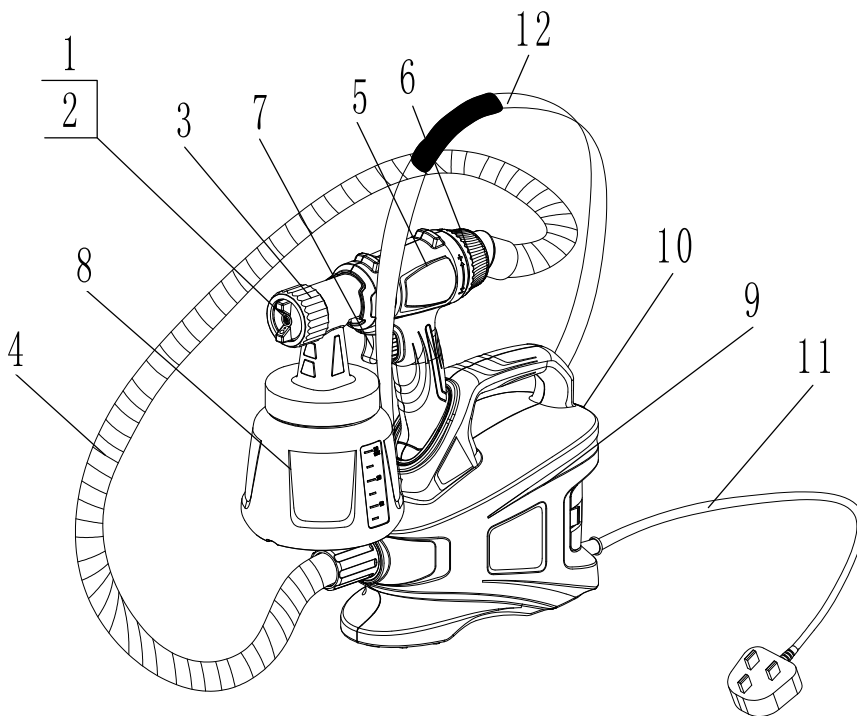

### Exploratory diagram MYESG01:

- |                               |                    |
|-------------------------------|--------------------|
| 1. Air cap                    | 7. Trigger         |
| 2. Nozzle                     | 8. Container       |
| 3. Union nut                  | 9. Motor           |
| 4. Air hose                   | 10. ON/OFF switch  |
| 5. Spray gun                  | 11. Mains cable    |
| 6. Paint flow adjustment knob | 12. Shoulder strap |

### Preparation of the coating material:

Information regarding a sprayable dilution is normally not to be found on the manufactures label.

Please use the viscosity table (below), viscosity = thickness of the coating material.



## Measuring the viscosity:

### Using the viscosity measuring cup

1. Thoroughly stir the coating material before starting measurement.
2. Immerse the viscosity measuring cup (contents 100cm<sup>3</sup>) completely in the coating material below rim level and allow to fill.
3. Lift the viscosity measuring cup and measure the time in seconds until the flow of coating material stops.
4. This run-out time is called DIN seconds (DIN-s).

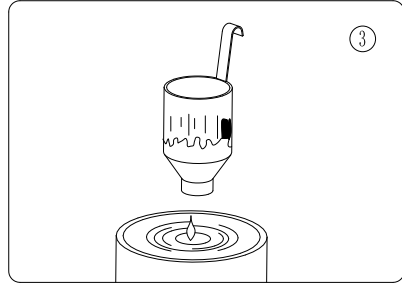

### Viscosity table:

| COATING MATERIAL                | VISCOSITY DIN-S |
|---------------------------------|-----------------|
| Solvent containing gloss paints | 15-50           |
| Primers                         | 25-50           |
| Mordants/Dye                    | undiluted       |
| Component paints                | 20-50           |
| Clear varnishes                 | 15-40           |
| Water-dilutable gloss paints    | 20-40           |
| Motor-vehicle enamels           | 20-40           |
| Wood preservatives              | undiluted       |

Paint is "thinned" by adding the substance upon which the paint is based. If it is water-based paint then water is added; if oil based then mineral spirit or manufacturer's recommended thinner is added. If the paint requires thinning, start with a 10% dilution of the paint. To do this, partially fill a container with one quart of paint. The viscosity cup supplied with the unit holds 1/10 of a quart. Block the hole in the viscosity cup with your finger and fill up with the required thinner. Add the thinner to the paint and stir, and re-measure the viscosity. If the paint requires additional thinning, repeat this step by adding 5% (5% will be equal to half a viscosity cup) with the required thinner until desired viscosity is achieved.

## Starting up:

### 1. Attach air hose.

*Device end (fig.4)* - Connect air hose connector to the device by pushing it firmly into place.

*Spray gun end (fig.5)* - Connect the air hose connector to the spray gun by pushing it firmly into the adjusting knob.

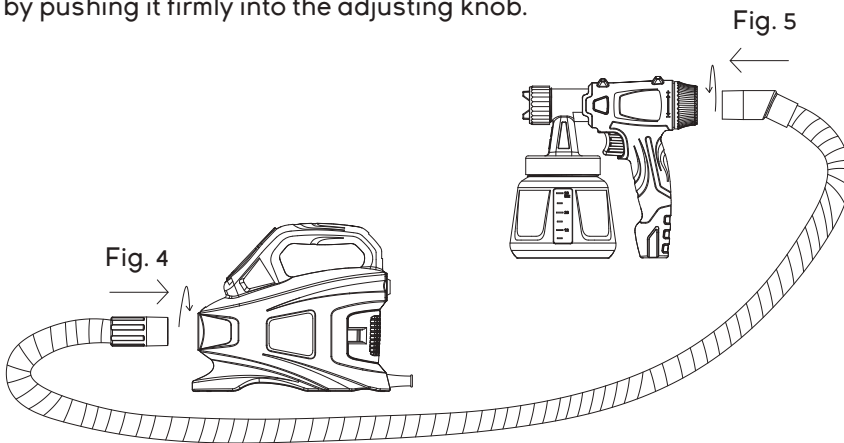

### 2. Unscrew the container from the spray gun.

### 3. Adjust the suction tube in the paint container accordingly.

It should be possible to spray the contents of the container leaving hardly any material left in the container.

Fig. 6

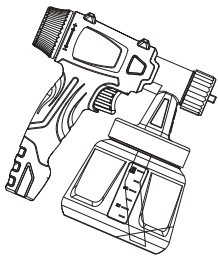

*Spraying with horizontal objects (fig.6)*

Turn the suction tube A to face forwards.

Fig. 7

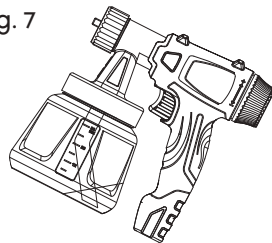

*Spraying overhead objects (fig.7)*

Turn the suction tube A to face backwards.

4. Fill container with coating material. Screw firmly onto spray gun.
5. Place the spray gun in the spray gun holder.
6. Only place the device on an even and clean surface.
7. Before connecting to the mains ensure that the mains voltage corresponds with the details on the rating plate and the power switch on the unit is switched OFF.
8. Remove the spray gun from the spray gun holder and point at object to be sprayed. Turn on using ON/OFF switch on the device.
9. Adjust the spraying pattern and amount of material; set the amount of air and pressure, see fig.8,9,10.
10. Press the trigger on the spray gun.

### Note:

When the device is switched on, air will continually flow from the air cap - this is normal.

Fig. 9

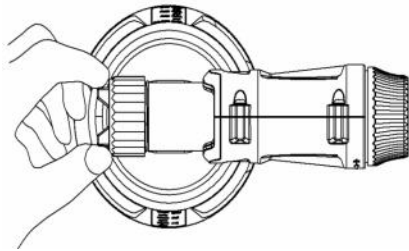
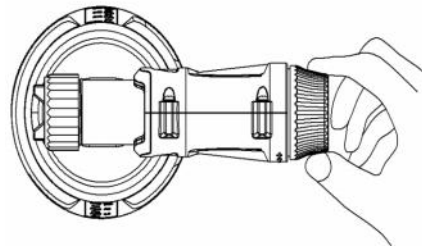

Fig. 10



### Adjusting for the required spray effect:

With the union nut (3) turn the air cap (1) to the required spray pattern.

## Caution:

Never open the trigger when making adjustments on the air cap.

## Adjusting the spray gun:

### Choice of spraying effects

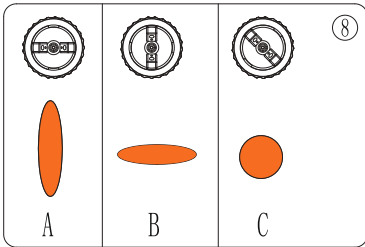

*A = vertical flat jet* - for horizontal surfaces

*B = horizontal jet* - for vertical surfaces.

*C = round jet* - for corners, edges and other hard to reach areas.

## Adjusting the amount of material:

Adjust the amount of material by turning the adjustment screw.

*+ turn to the right* - more material

*- turn to the left* - less material

## Spraying technique:

The spraying result depends considerably on how smooth and clean the surface is before spraying begins. For this reason the surface should be carefully prepared and kept free from dust.

Surfaces not to be sprayed should be covered with sticky tape and newspaper.

It is advisable to carry out a trial spraying onto cardboard or a similar surface to find the most suitable spray gun adjustments.

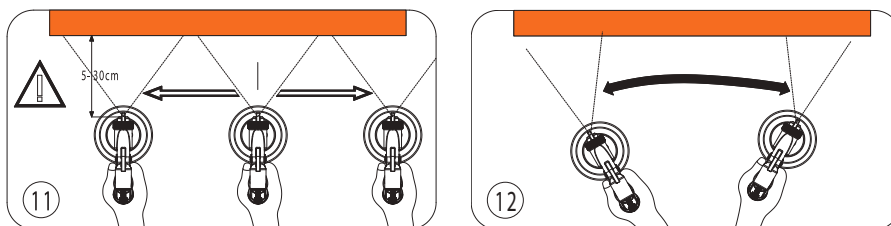

### Right Way (fig.11)

*Always hold the spray gun at an even distance of approx. 5-15cm from the object to be sprayed. Move the spray gun evenly across or up and down, depending on the adjusted spraying effect. An even movement of the spray gun will give a uniform and even surface quality.*

### Wrong Way (fig.12)

*Excessive paint mist will form an uneven surface finish.*

If coating material builds up on the nozzle (2) and air cap (1) clean both parts with solvent or water.

- Turn off device and unplug from power source.
- Place spray gun in spray gun holder.
- Remove parts for cleaning.

### Closing down and cleaning:

1. Turn off device. Open trigger so that the coating material in the spray gun runs back into the container.
2. Unscrew the container. Return the remaining coating material into the material tin.
3. Clean the container and the paint suction tube with a brush.
4. Fill the container with solvent or water and screw back into place.

**Only use solvent with a flash point of over 32°C**

Turn on device and spray the solvent or water into a container.

Due to high air volume some solvent or water will be deposited outside the container.

5. Repeat the above procedure until clear solvent or water comes out of the spray gun nozzle.

6. Turn off device and unplug from power outlet.
7. Then completely empty the container. Always keep the container free of coating material and check for damage.
8. Clean the outside of the spray gun and container with a cloth soaked in solvent or water.
9. Unscrew the union nut. Remove air cap. Clean the air cap and nozzle with brush and solvent or water.

### Changing the washable air filter:

Unlike most paint sprayers, the MYLEK Paint Sprayer has a unique, washable filter and if cleaned after every use will prolong the life of your machine giving you many more years use compared to other conventional units.

- Switch off the power and unplug from the power source.
- Remove the air intake guard from the rear of the motor unit by simply pushing in the two clips at either side of the air intake guard.
- Remove the sponge like filter and wash with lukewarm soapy water and rinse.
- Leave to dry completely.
- Place back into the correct position in the air intake guard and push back into place at the rear of the unit making sure it clips securely back into position. The unit is now ready for use.
- The unit is supplied with one extra filter, please keep this stored in a safe place for future use.

### PAT Testing:

When used in a workplace, this product must be safety-tested yearly by a qualified electrician (PAT Tested) in order to comply with the Electricity at Work Regulations. We recommend that it is PAT tested regularly when used in a domestic environment.

## Troubleshooting:

| PROBLEM   | CAUSE  | REMEDY  |
|---|--|---|
| No coating material is coming out of the nozzle | The nozzle is blocked.                                   | Clean   |
|   | The paint suction tube is blocked.                       | Clean   |
|   | The small hole in the paint suction tube is blocked.     | Clean   |
|   | Material adjustment knob turned too far to the left (-). | Turn to the right (+)                             |
|   | The paint suction tube is loose.                         | Tighten the pipe                                  |
|   | No pressure is built up in the container.                | Tighten container                                 |
| The coating material drips from the nozzle      | The nozzle is loose.                                     | Tighten   |
|   | The nozzle is worn.                                      | Replace   |
|   | Build up of coating material in the air cap and nozzle.  | Clean   |
| Spray too coarse                                | Coating materials viscosity is too high                  | Dilute  |
|   | Too much material.                                       |   |
|   | Material adjustment knob turned too far to the right(+). | Turn material adjustment knob to the left (-)     |
|   | Nozzle dirty.  | Clean   |
|   | Air filter very dirty.                                   | Clean or replace                                  |
|   | Not enough pressure built up in container.               | Tighten container                                 |
| The spray jet pulses                            |  |   |
| Coating material in container is running out.   |  |   |
| The small hole in the ascending pipe is blocked | Refill   |   |
|   | Clean  |   |
| Air filter very dirty.                          | Clean or replace   |   |
| Run in the coating material                     | Too much coating material applied                        | Turn the material adjustment knob to the left (-) |
| Too much coating material mist (overspray)      | The distance to the object to be sprayed is too large.   | Reduce spraying distance                          |
|   | Too much coating material applied                        | Turn material adjustment knob to the left (-)     |



## Environmental Responsibilities



Meaning of crossed-out wheeled dustbin:

Do not dispose of electrical appliances as unsorted municipal waste, use separate collection facilities.

Contact your local council for information regarding the collection systems available.

If electrical appliances are disposed of in landfills or dumps, hazardous substances can leak into the groundwater and get into the food chain damaging your health and well-being.

When replacing old appliances with new ones, the retailer is legally obligated to take back your old appliance for disposal free of charge.

## 12 Months Limited Warranty

If within 12 months from the date of purchase you experience any problems with your product, please return the product to its distributor/dealer for repair or replacement. This warranty DOES NOT COVER normal wear, or any damage as a result of accidents, misuse, abuse or negligence.

## SERVICE WARRANTY

Hygiene Supplies Direct guarantees the product free from defects in materials and workmanship for a period of 1 year from date of purchase.

Should this unit be operated under conditions other than those recommended, at voltages other than the voltage indicated on the unit, or any attempts made to service or modify the unit, then the warranty will be rendered void. The product you buy may sometimes differ slightly from illustrations. This warranty is in addition to, and does not affect, your statutory rights.

If you have any problems with this product, please call our Help Desk on 0800 091 3171 or email [sales@hygienesuppliesdirect.com](mailto:sales@hygienesuppliesdirect.com)

NLC Services Ltd, Brierley Hill, DY5 3JZ declares that the Electric Spray Gun is exclusively manufactured and imported for Mylek.