

MYZEK[®] COMPAKT



18V Cordless
Li-ion Drill

MY18VCB

User Manual -
Please read and retain
for future reference



www.hsdonline.co.uk

Introduction

General Information

Please read the entire instruction manual before using the product and then save it for future reference. We reserve the right for any errors in text or images and any necessary changes made to technical data. If you have any questions concerning technical problems please contact our Customer Services on 0800 091 3171.

Contents

1. Introduction
2. Safety instructions
3. Operation
4. Maintenance
5. Environmental Responsibilities
6. Warranty

Safety Instructions

General safety instructions for power tools:

Warning: Read all the instructions. Failure to comply with the following instructions can lead to electric shocks, fires or serious injury.

SAVE THESE INSTRUCTIONS.

The term "power tool" in the following text refers to your handheld mains operated or battery operated tool.



Symbols



Read the manual



Warning



Wear ear protection



Wear dust mask



Indoor use only



Do not expose to rain or water



Do not burn

General Safety Instructions



WARNING! Read all instructions. Failure to follow all instructions listed below may result in electric shock, fire and/or serious injury. The term "power tool" in all of the warning listed below refers to your mains operated (corded) power tool or battery-operated (cordless) power tool.

SAVE THESE INSTRUCTIONS

1. Keep work area clean and well lit. cluttered or dark areas invite accidents.
2. Do not operate power tools in explosive atmospheres. such as in the presence of flammable liquids, gases or dust. Power tools create sparks which, may ignite the dust or fumes.
3. Keep children and bystanders away while operating a power tool. Distractions can cause you to lose control.

Personal safety

1. Stay alert, watch what you are doing and use common sense when operating a power tool. Do not use a power tool while you are tired or under the influence of drugs, alcohol or medication. A moment of inattention while operating power tools may result in serious personal injury.
2. Use safety equipment. Always wear eye protection. Safety equipment such as dust mask, non-skid safety shoes, hard hat, or hearing protection used for appropriate conditions will reduce personal injuries.
3. Avoid accidental starting. Ensure the switch is in the off-position before plugging in. Carrying power tools with your finger on the switch or plugging in power tools that have the switch on invites accidents.
4. Remove any adjusting key or wrench before turning the power tool on. A wrench or a key left attached to a rotating part of the power tool may result in personal injury.
5. Do not overreach. Keep proper footing and balance at all times. This enables better control of the power tool in unexpected situations.
6. Dress properly. Do not wear loose clothing or jewellery. Keep your hair, clothing and gloves away from moving parts. Loose clothes, jewellery or long hair can be caught in moving parts.
7. If devices are provided for the connection of dust extraction and collection facilities, ensure these are connected and properly used. Use of these devices can reduce dust-related hazards.

Power tool use and care

1. Do not force the power tool. Use the correct power tool for your application. The correct power tool will do the job better and safer at the rate for which it was designed.
2. Do not use the power tool if the switch does not turn it on and off. Any power tool that cannot be controlled with the switch is dangerous and must be repaired.
3. Disconnect the plug from the power source and/or the battery pack from the power tool before making any adjustment, changing accessories or storing power tools. Such preventive safety measures reduce the risk of starting the power tool accidentally.
4. Store idle power tools out of the reach of children and do not allow persons unfamiliar with the power tool or these instructions to operate the power tool. Power tools are dangerous in the hands of untrained users.
5. Maintain power tools. Check for misalignment or binding of moving parts, breakage of parts and any other condition that may affect the power tool's operation. If damaged, have the power tool repaired before use. Many accidents are caused by poorly maintained power tools.
6. Keep cutting tools sharp and clean. Properly maintained cutting tools with sharp cutting edges are less likely to bind and are easier to control.
7. Use the power tool, accessories and tool bits etc. In accordance with these instructions, taking into account the working conditions and the work to be performed. Use of the power tool for operations different from those intended could result in a hazardous situation.

Battery tool use and care

1. Ensure the switch is in the off position before inserting battery pack. Inserting the battery pack into power tools that have the switch on invites accidents.
2. Recharge only with the charger specified by the manufacturer. A charger that is suitable for one type of battery may create a risk of fire when used with another battery pack.
3. Use power tools only with specifically designated battery packs. Use of any other battery packs may create a risk of injury and fire.
4. When battery pack is not in use, keep it away from other metal objects like paper clips, coins, keys, nails, screws or other small metal objects, that can make a connection from one terminal to another. Shorting the battery terminals together may cause burns or a fire.
5. Under abusive conditions, liquid may be ejected from the battery; avoid contact. If contact accidentally occurs, flush with water. If liquid contacts eye, additionally seek medical help. Liquid ejected from the battery may cause irritation or burns.



COMPONENT LIST TECHNICAL DATA

1. 0.8-10mm chuck
2. Torque setting
3. Forward/Reverse rotation control
4. Soft grip handle
5. Battery pack release button
6. Battery pack
7. Trigger switch
8. LED sight light
9. Battery charge indicator

Not all the accessories illustrated or described are included in standard delivery.

ACCESSORIES

1300MAH LI-ION battery pack	1pc
Fast charger	1pc
Twist drills	6pcs
Screwdriver bits	6pcs
Bit holders	1pc

We recommend that you purchase your accessories from the same store that sold you tools.

TECHNICAL DATA

Voltage: 18V (LI-ION)
No-load speed: 0-700RPM
Max. torque: 28Nm
Torque setting: 18+1
0.8-10mm keyless chuck

CHARGER PROCEDURE

Recharging the batteries

A CHARGING THE INSTALLED

BATTERY: Do not use another battery charger. When the battery is empty, the machine is switched off by means of a protective circuit : The chuck no longer rotates. In a warm environment or after heavy use, the battery pack may become too hot. Allow time for battery to cool down before recharging.

B IMPORTANT NOTES CHARGING THE

BATTERY: The battery in your new tool is not charged when it leaves the plant. Therefore it must be charged for 1 hour before using for the first time!

1 When the battery charger adaptor is plugged into the battery and the LED light shows Red on the adaptor, the battery is ready for charging. When the battery LED light shows Green on the adaptor, the battery is fully charged and ready for use.

2 Do not leave the battery connected to the charger for longer than 5 hours. Please remember this is a 3-5 hour charging unit.



WARNING: When battery charge runs out after continuously use or exposure to direct sunlight or heat, allow time for the battery to cool down before recharging to achieve the full charge

To remove or install the battery pack

- 1 Hold down the battery release button.*
- 2 Slide the battery out.*

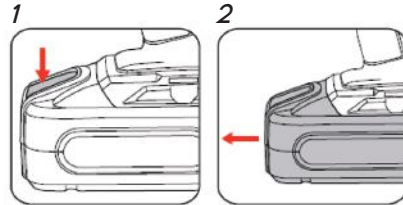

Removing/installing battery pack

OPERATING INSTRUCTIONS

1 TRIGGER SWITCH

Depress to start and release to stop your drill. The trigger switch is fitted with a brake function which stops your chuck immediately when you quickly release the switch. It is also a variable speed switch that delivers higher speed and torque with increased trigger pressure. Speed is controlled by the amount of trigger switch depression.

2 TRIGGER SWITCH LOCK

The trigger switch can be locked in OFF position. This helps to reduce the possibility of accidental starting when not in use. To lock the switch, place the forward and reverse rotation

selector in the centre position by pushing it on either side of the drill.

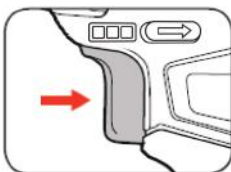

3 REVERSIBLE

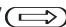
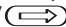
The forward/reverse rotation control located above the trigger switch control the direction of rotation. For drilling and screw driving use forward rotation marked “” (lever is moved to the left). Only use reverse rotation marked “” (lever is moved to the right) to remove screws or release a jammed drill bit. When the selector is in the centre position, the switch is locked.

4 CHUCK ADJUSTMENT (FIG G)

To open the chuck jaws rotate the front section of the chuck. Insert the drill bit between the chuck jaws and rotate the front section in the opposite direction. Ensure the drill bits is in the centre of the chuck jaws. Finally, firmly rotates the front chuck section in the opposite directions. Your drill bit is now clamped in the chuck.

Fig.G



5 TORQUE ADJUSTMENT (FIG G) (Screw driving force of your drill driver)

The torque is adjusted by rotating the torque adjustment ring. The torque is greater when the torque adjustment ring is set on a higher setting. The torque is less when the torque adjustment ring is set on a lower setting.

Make the setting as follows:

- 1-5 for driving small screws
- 6-11 for driving screws into soft material
- 11-15 for driving screws into soft and hard material
- 15-18 for driving larger screws
-  for heavy drilling

6 USING THE SIGHT LIGHT

The sight light allows you to keep a clear view under less illuminated circumstances. To turn on the light simply press the trigger switch. When you release the trigger switch, the light switches off.

7 DRILL

When drilling into a hard smooth surface, use a centre punch to mark the desired hole location. This will prevent the drill bit from slipping off centre as the hole is started. Hold the tool firmly and place the tip of the bit at the point to be drilled. Depress the trigger switch to start the tool. Move the drill bit into the workpiece, applying only enough pressure to keep the bit cutting. Do not force or apply side pressure to elongate a hole.

NOTE: If your tool stops working when drilling a hole automatically, it's normal. This is the electrical protection for battery. Completely release the trigger switch, then depress it to start the tool again.

DISPOSAL OF AN EXHAUSTED BATTERY PACK

To preserve natural resources, please recycle or dispose of the battery pack properly. This battery pack contains LI-ION batteries. Consult your local waste authority for information regarding available recycling and/or disposal options. Discharge your battery pack by operating your drill, then remove the battery pack from the drill housing and cover the battery pack connections with heavy duty adhesive tape to prevent short circuit and energy discharge. Do not attempt to open or remove any of the components.

Environmental Responsibilities



Meaning of crossed-out wheeled dustbin:

Do not dispose of electrical appliances as unsorted municipal waste, use separate collection facilities.

Contact your local council for information regarding the collection systems available.

If electrical appliances are disposed of in landfills or dumps, hazardous substances can leak into the groundwater and get into the food chain damaging your health and well-being.

When replacing old appliances with new ones, the retailer is legally obligated to take back your old appliance for disposal free of charge.

SERVICE WARRANTY

Hygiene Supplies Direct guarantees the product free from defects in materials and workmanship for a period of 1 year from date of purchase.

Should this unit be operated under conditions other than those recommended, at voltages other than the voltage indicated on the unit, or any attempts made to service or modify the unit, then the warranty will be rendered void. The product you buy may sometimes differ slightly from illustrations. This warranty is in addition to, and does not affect, your statutory rights.

If you have any problems with this product, please call our Help Desk on 0800 091 3171 or email sales@hygienesuppliesdirect.com

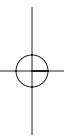

Hygiene Supplies Direct Ltd, Castleford, England WF10 1PA
declares that the 18V Cordless Drill is exclusively manufactured and imported for Mylek.

www.hsdonline.co.uk

