

BEFORE USE:

MYZEK®

Please read the instructions carefully. You must inspect the appliance including its cable and plug for any signs of damage. If the product is damaged, DO NOT USE and contact your supplier immediately for refund or replacement.

This product is only suitable for well insulated spaces or occasional use.

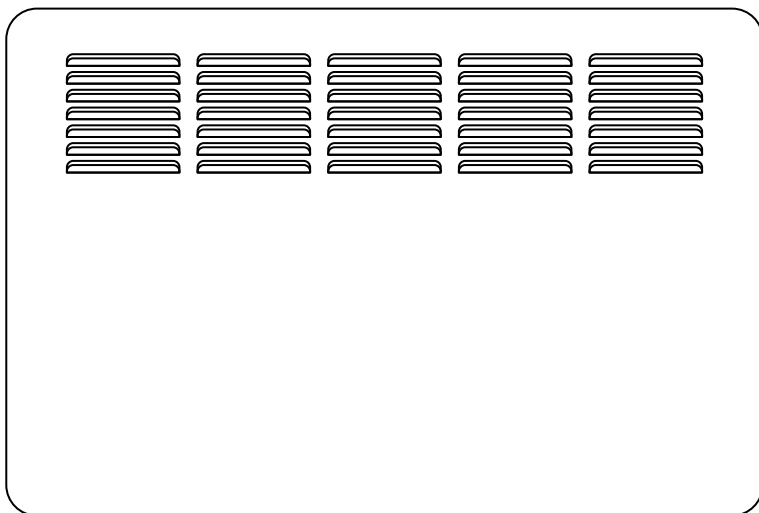

V 2021-12

INSTRUCTION MANUAL FOR MODELS

WIFI PANEL HEATER

MHPH05-10E / MHPH05-15E / MHPH05-20E

| GENERAL INFORMATION

Thank you for choosing the Mylek WiFi panel heater with Open window function. Please take time to carefully read and understand the entire instruction manual before using the product and then save it for future reference. We reserve the right for any errors in text or images and any necessary changes made to technical data. If you have any questions concerning operational or technical problems please contact our Customer Services on **0800 091 3171**.

| BEFORE USING THIS HEATER

When using electrical appliances, basic precautions should always be followed to reduce the risk of fire, electric shock, and injury to persons. This includes but is not limited to the following.

CAUTION

This appliance is not intended for use by persons (including children) with reduced physical, sensory or mental capabilities, or lack of experience and knowledge of the product. The appliance is to be operated by responsible adults only after reading and understanding these instructions. Children should be supervised at all times to ensure that they do not play with the appliance. Children under 16 years should not operate the unit or carry out maintenance and/or clean the unit. Any infirmed persons in the vicinity of the unit should be accompanied by a responsible and competent

able bodied adult. Remove the packing and make sure that the appliance is intact. If there is any doubt concerning the integrity of the unit do not use the appliance and contact our recommended after-sales service.

Do not leave any packaging materials within easy reach of children. Before switching on appliance check if the electrical voltage and frequency of the circuit correspond to those indicated on the appliance. Use the appliance only for the stated purpose, namely as a heater for domestic use. Do not use it for any other application as it could be dangerous.

| IMPORTANT SAFETY REQUIREMENTS

- This appliance can be used by children aged from 8 years and above and persons with reduced physical, sensory or mental capabilities or lack of experience and knowledge if they have been given supervision or instruction concerning use of the appliance in a safe way and understand the hazards involved. Children shall not play with the appliance. Cleaning and user maintenance shall not be made by children without supervision.
- Children of less than 3 years should be kept away unless continuously supervised.
- Children aged from 3 years and less than 8 years shall only switch on/off the appliance provided that it has been placed or installed in its intended normal operating position and they have been given supervision or instruction concerning use of the appliance in a safe way and understand the hazards involved. Children aged from 3 years and less than 8 years shall not plug in, regulate

and clean the appliance or perform user maintenance.

- CAUTION - Some parts of this product can become very hot and cause burns. Particular attention has to be given where children and vulnerable people are present.
- If the supply cord is damaged, it must be replaced by the manufacturer, its service agent or similarly qualified persons in order to avoid a hazard.
- CAUTION: In order to avoid a hazard due to inadvertent resetting of the thermal cutout, this appliance must not be supplied through an external switching device, such as a timer, or connected to a circuit that is regularly switched on and off by the utility.
- The heater must not be located immediately below a socket-outlet.
- Means for disconnection having a contact separation in all poles must be incorporated in the fixed wiring in accordance with the wiring rules.
- For correct installation on the wall, thanks to refer to 'Installation on wall' part.
- Fixed heaters are to be installed so that switches and other controls cannot be touched by a person in the bath or shower.



WARNING: In order to avoid overheating, do

not cover the heater.

WARNING: this product should only be installed in Zone 2 and above only if fitted in a bathroom according the national wiring rules.

Note: The drawing below is for reference only.

If this unit is fitted in a bathroom then it should be fitted by a qualified electrician.

In the case as of buildings room, a room receiving a bath or a shower and socket-outlets lower or equal to 32 A the circuit corresponding must be protected by a device with differential residual current (RCD) lower or equal to 30 mA.

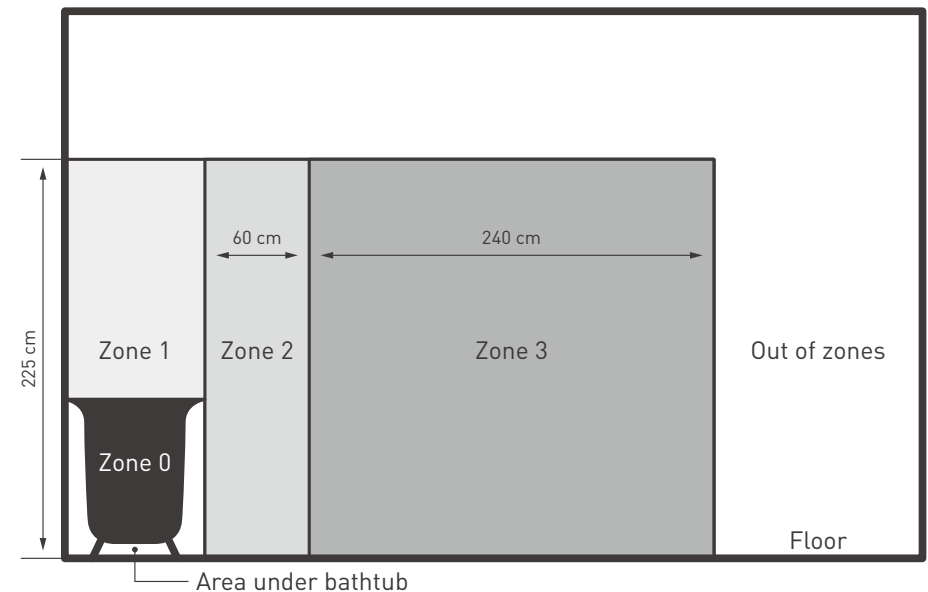

**THIS PRODUCT IS FOR ROOM HEATING
FOR HOUSEHOLD USE ONLY**

| SPECIFICATIONS

Model No.	RATED VOLTAGE	RATED POWER
MHPH05-10E	AC230-240V, 50-60Hz	1000W
MHPH05-15E	AC230-240V, 50-60Hz	1500W
MHPH05-20E	AC230-240V, 50-60Hz	2000W

| STRUCTURE AND PARTS

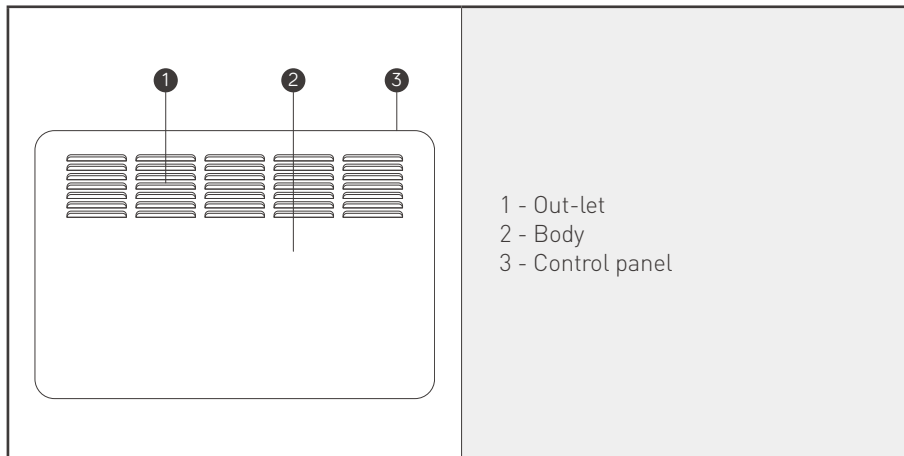

| INSTALLATION ON THE WALL

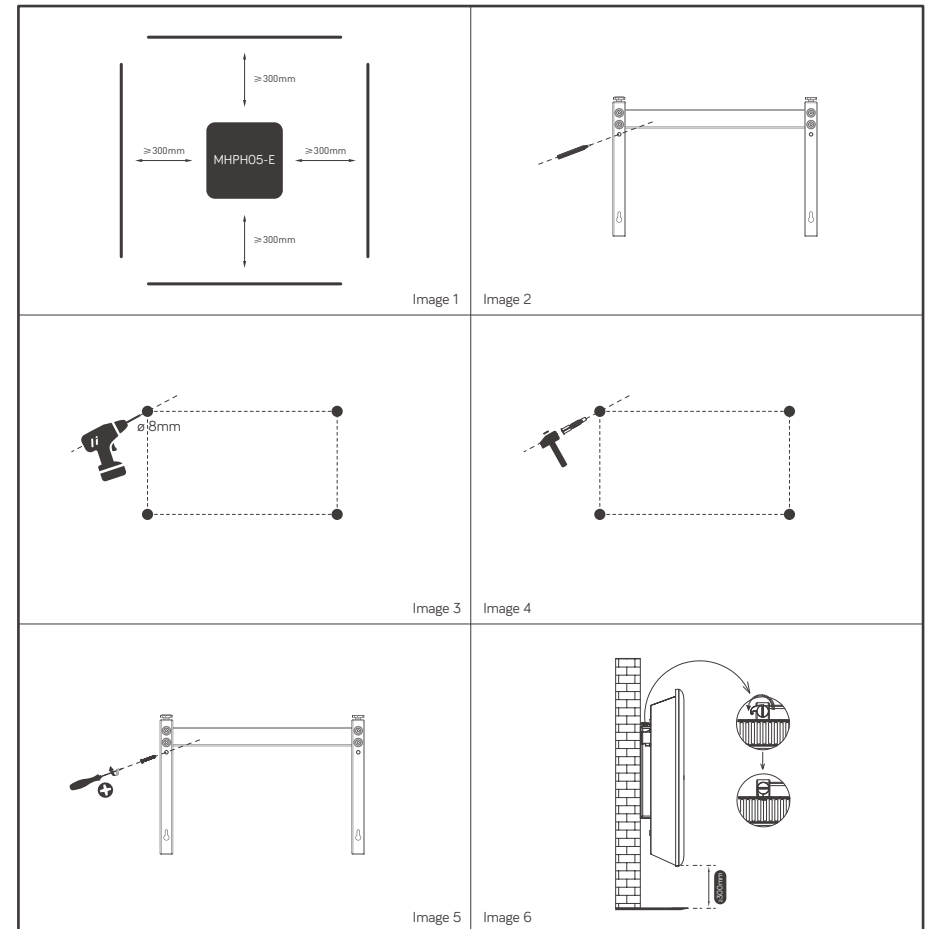

Figure 1

- For wall mounting, carefully remove the already constructed hanging bracket from the rear of the heater by turning the two plastic securing grips located at the top of the bracket. It is good practice to remove the bracket and replace a few times so you are familiar on how it attaches before securing to the wall.
- Using the hanging bracket as a template, place the hanging bracket level against the wall as a guide ruler (please make sure the holes are parallel level), use a marker pen to mark the hole position. Image 2 on Figure 1 above.
- Drill holes on the wall with Ø8mm drill bit. Image 3 on Figure 1 above.

- Insert the plastic wall plugs. Image 4 on Figure 1 above.
- Securely fasten the hanging bracket to the wall with the screws provided. Make sure the hanging bracket is in the correct direction. Image 5 on Figure 1 above.
- Gently insert the bottom of the heater to the hanging bracket first and then push the top of the heater body onto the hanging bracket. It is good practice to try attaching the hanging bracket to the heater and taking off, so you are familiar with how it attaches and detaches.
- When the heater is attached to the hanging bracket, secure into place by turning the two plastic securing grips. Image 6 on Figure 1 above.

Warning:

Be sure to keep a distance around the heater of at least 30cm (300mm) see image above.

Warning! When drilling holes, always check to ensure there is no electrical wiring, gas pipes, water pipes etc in the area to be drilled.

To fix the feet, pls see the picture as below:

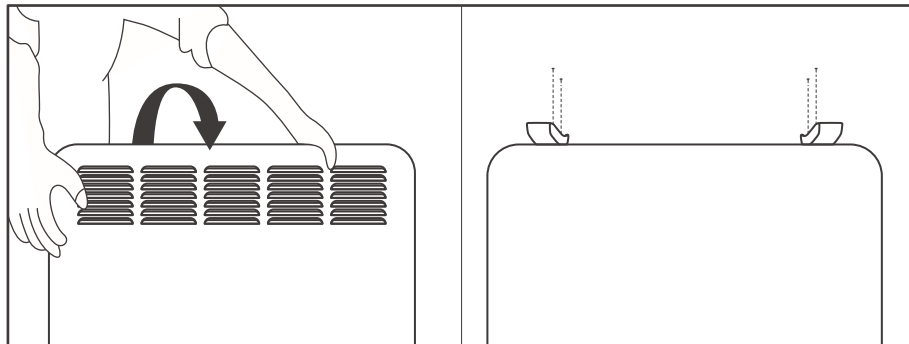

If not use for wall-mounted, pls assembly the feet as above picture.

| CONTROL PANEL AND SCREEN

6 Button:

- ⏻ Standby
- M Mode selection
- 📶 Wifi resetting
- ⊕ Increase function
- ⊖ Decrease function
- 🕒 Timer

1 Standby: on/off
 2 Heating status
 3 WiFi function
 4 Comfort mode
 5 ECO mode
 6 Timer

| HOW TO USE

- Plug the appliance into a AC 230-240V 50-60Hz socket and press on/off switch, the unit will “beep” once. The indicator light illuminates for standby mode.
- Press to turn on the heater. For the first use the heater is in factory default settings as shown below: (If default settings are different, it will simply be because the unit has been quality tested after production).
 Heating mode: Comfort mode
 Target temperature setting: 22°C
 Day: 1(Monday), Time: 00:00 (Off)
 Window open function: Off
 Timer: Off
- Press to turn off the heater and put into standby mode when not in use.
- Unplug the product from the power source when not in use.

TIME AND DAY SETTINGS

- Press **⏸** for 3-4 seconds, the screen will flash " **⌚**", press **+** and **-** to choose the current day, 1 for Monday, 2 for Tuesday etc. When the current day is reached press **⏸** to confirm the current day setting.

1	Monday	2	Tuesday
3	Wednesday	4	Thursday
5	Friday	6	Saturday
7	Sunday		

- After pressing **⏸** to confirm the day setting the screen will display " **H**". Press **+** and **-** to set the current hour. When current hour is set press **⏸** to confirm.
- After pressing **⏸** to confirm the current hour setting the screen will display " **M**".
- Press **+** and **-** to set the current minute.
- Press **⏸** to confirm all settings.

Please note: If the unit is in standby mode the unit will keep the clock and day settings. Depending how long the unit is switched off at the mains or unplugged, the clock and day may need to be reset when powered back up.

HEATING MODE

- Press **M** to enter mode selection. By pressing **M**, heating mode runs in a continuous cycle as below:

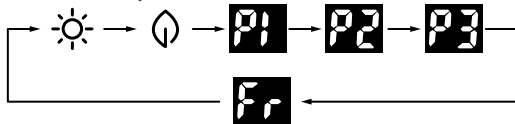

- ☀️ Comfort mode:** Press **+** and **-** to set the temperature from 5-35 °C.
- ⬆️ ECO mode:** Press **+** and **-** to set the temperature from 1-31 °C.
Note: ECO mode=Comfort mode - 4 °C.
- Use of countdown timer: In standard heating ECO or Comfort mode you can leave the model on permanent or programme the countdown timer so the unit turns off after your set hours have elapsed, press the **⏸** button once and the " **⌚**" will flash, using the **+** or **-** key choose your set hour from 1-24 hours, once chosen

press **⏸** the and the display will revert back to your set temperature, the **⏸** will illuminate to show you have set the countdown timer. The clock will countdown 1 hour at a time from your set hours and turn off when your set hours have counted down. You can check the set countdown hours left by simply pressing the **⏸** once and once again to revert back to set temperature.

- Anti-frost mode:** Press the **M** button until the screen displays " **Fr**". In this mode you cannot set the countdown timer or adjust the temperature or set the window open function. The target temperature is 7°C, if the room falls to 7°C or below, the unit will operate. This is a preferred mode for garages, caravans etc.

Using the Preset programmes 1 and 2:

Note: Clock and day setting must be set for correct usage of P1/P2 programmes. It is advised to set day and clock in advance for the programmes to work correctly. Programmes P1 and P2 are not adjustable and are pre-set.

To choose programme P1 or P2 below press the **M** button until P1 or P2 is chosen. Set your preferred room temperature by pressing the **+** or **-** button. Once temperature is chosen, the display will revert back to the chosen programme P1 or P2. The unit will now operate in P1 or P2 programme.

See below for pre-set settings over a 7 day period for programmes P1 and P2.

- P1 (Figure 1) is a preset programme Monday-Sunday. See image below for P1 preset programme which shows the unit settings in a 24hr period which will repeat over a 7 day period. (The image below (Figure 1) is just for illustration purposes only and not shown on the LED display.)

P1: (Monday-Sunday) preset program.

00:00am – 01:00am ☀️ comfort mode, 01:00am – 07:00am ⬆️ ECO mode and
07:00am – 00:00am ☀️ comfort mode.

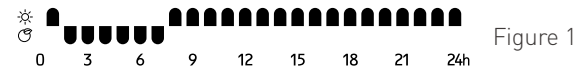

- P2 (Figure 2) is a preset programme Monday-Friday and Saturday - Sunday. See image below for P2 preset programme which shows the unit settings in a 24hr period which will repeat over a 7 day period. (The images (Figure 2 and 3) below are just for illustration purposes only and not shown on the LED display.)

P2:(Monday-Friday) preset program

00:00am – 01:00am ☀️ comfort mode, 01:00am – 05:00am ⬆️ ECO mode,
05:00am – 09:00am ☀️ comfort mode, 09:00am – 19:00pm ⬆️ ECO mode,
19:00pm – 00:00am ☀️ comfort mode.

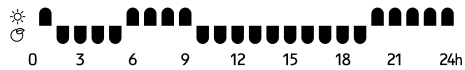

Figure 2

P2:(Saturday-Sunday) preset program

00:00am – 01:00am ☀️ comfort mode, 01:00am – 08:00am 🌿 ECO mode,
 08:00am – 11:00am ☀️ comfort mode, 11:00am – 13:00pm 🌿 ECO mode,
 13:00pm – 16:00pm ☀️ comfort mode, 16:00pm – 20:00pm 🌿 ECO mode and
 20:00pm – 00:00am ☀️ comfort mode.

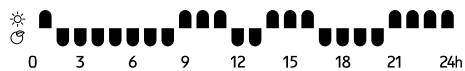

Figure 3

- P3: Can be adjusted to meet your requirements. P3 is the only programme that can be set to your requirements, each day and hour can be set individually by following the instructions below. Below are examples of what you can adjust P3 programme to, although you can adjust this programme to meet your own requirements. (Images (Figure 4 and 5) below are just for illustration purposes only and not shown on the LED display.)

P3:(Monday-Friday) Adjustable program.

00:00am – 01:00am ☀️ comfort mode, 01:00am – 05:00am 🌿 ECO mode,
 05:00am – 09:00am ☀️ comfort mode, 09:00am – 12:00pm 🌿 ECO mode,
 12:00pm – 16:00pm ☀️ comfort mode, 16:00pm – 18:00pm 🌿 ECO mode and
 18:00pm – 00:00am ☀️ comfort mode.

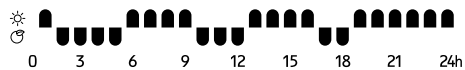

Figure 4

P3:(Saturday-Sunday) Adjustable program

01:00am – 05:00am 🌿 ECO mode 05:00am – 01:00am ☀️ Comfort mode

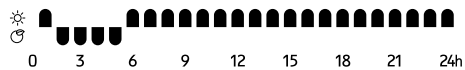

Figure 5

How to adjust P3 program setting:

It is good practice to spend time carefully studying and practising the programming of program 3 to fully understand the benefits which include time saving and cost savings. If at any time you require assistance on how to programme the product please call out dedicated customer service help line on Customer Services on 0800 091 3171.

- Press (M) until P3 mode is chosen and displayed; press (M) for 4 seconds until ☀️ is

displayed and flashing.

- Press (+) and (-) to choose the day you want to set from ☀️ - ☀️ (Monday-Sunday). Press (M) to confirm the Day.
- The screen displays 00 for hour setting, press (M) to choose either ☀️ Comfort mode or 🌿 ECO mode or press so neither the Comfort or ECO lights show so the heater will be in anti-frost mode. Press (+) to move to the next hour to set or to (-) the previous hour to set, choosing ☀️ Comfort mode, 🌿 ECO mode or show no lights for the unit to operate in anti-frost mode in this hour, repeat this process up to hour 23, after setting hour 23, press (+) to revert back to the current day and press (+) again to move to the next day to be set.
- Repeat the operation until you have completed the schedule of every hour and every day.
- When the last day is programmed ☀️, press (+) again to revert to P3.
- Your settings are then saved and can be adjusted at any time to suit your needs by simply following these instructions again.
- The temperature can be set to your needs by simply pressing the (+) or (-) button at any time whilst the unit is in operation.

| OPEN WINDOW FUNCTION

- When the product is in stand-by mode, press and hold (M) until the screen displays 00 or 0F, press (+) or (-) to set the open window function on or off.
- When the heater is working and the temperature of the room decreases 2 degrees within 2 minutes, the open window function will be activated, the heater will stop working. The screen will display E3.
- Press (M) to set the unit back to normal operation.

| WIFI CONNECTION

Use your phone to scan the QR code below or search for the **“TUYA SMART”** App to download and generate a free account. You can also visit **www.tuya.com** for more information. Please note Tuya are constantly developing and upgrading their Apps to make them more user friendly and sometimes, displays may differ slightly to the display shown in this manual due to upgrades. If you have any questions concerning technical problems, please contact our Customer Services on **0800 091 3171** quoting the model number found on the unit rating label.



Select your country code, enter your mobile number and select “Get” to receive a message containing your verification code. Enter your verification code and select “Login”.

When the first using to turn on the heater, the WiFi indicator light will flash, connect it in the APP.

Reset the WiFi, press  for 3 secs, the item will “beep”, the WiFi indicator light will flash rapidly, you can now connect within the APP.

A Quick connection: Turn on your bluetooth in you mobile phone, then set as following steps.



Press “+” in the right-top position and go to next step

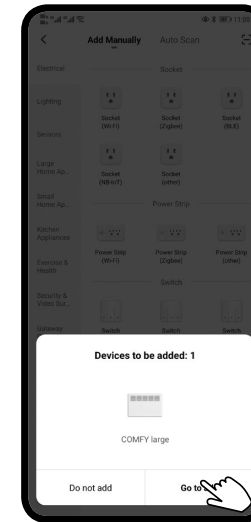

Press “Go to add”

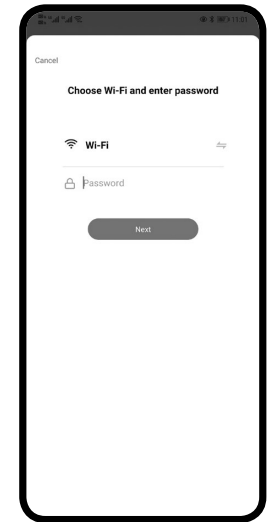

Select 2.4 GHz WiFi Network and enter the password, press next



Wait it's connected and press “Next”, the APP will show as below

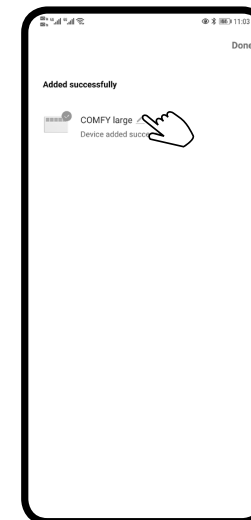

You can press to modify the name of the product

B Normal connection

If the bluetooth is not on, pls follow the next step:

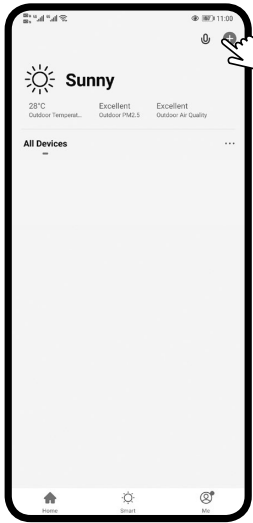

Press "+" in the right-top position and go to next step

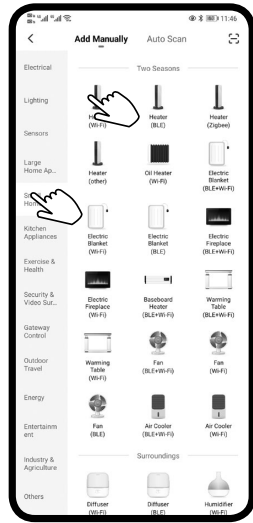

Choose small home appliance and heater

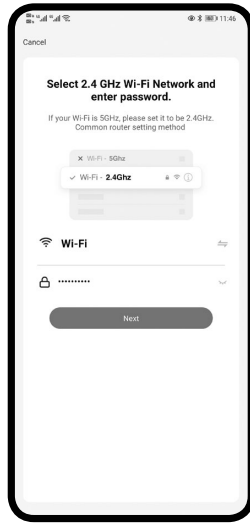

Select 2.4 GHz WiFi Network and enter the password, press next

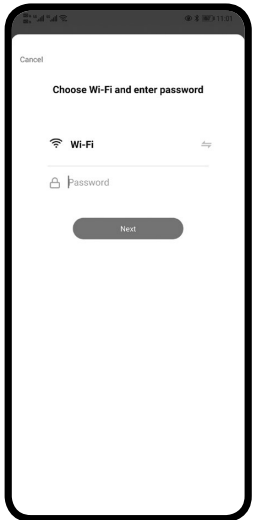

Select 2.4 GHz WiFi Network and enter the password, press next

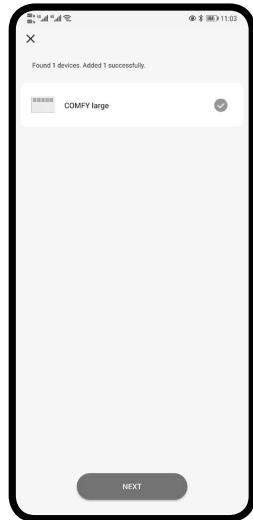

Wait it's connected and press "Next", the APP will show as below

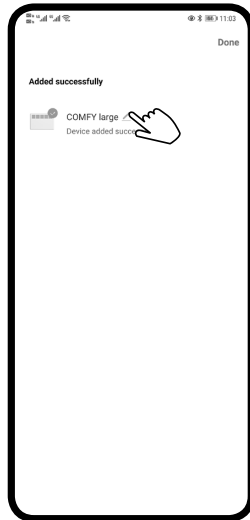

You can press to modify the name of the product

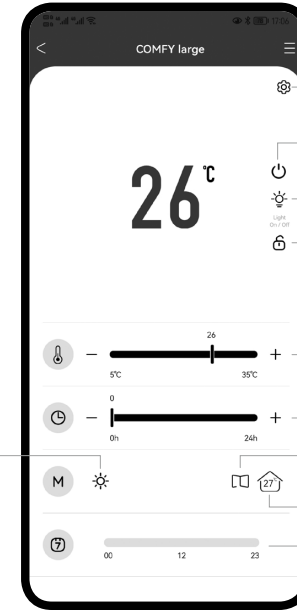

- Other functions
- Turn on/off the heater
- Night mode
- Children lock
- Target temperature setting
- Timer off
- Window open function
- Room temperature
- Smart timer

Working model selection

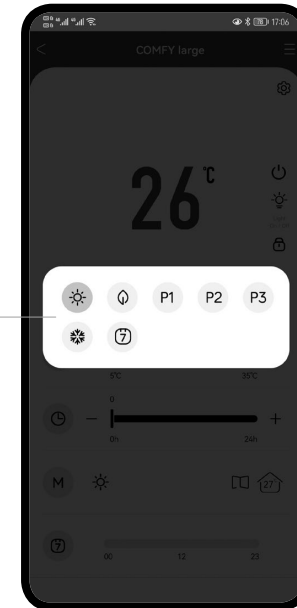

- Comfort mode
- ECO mode
- P1 Weekly program P1
- P2 Weekly program P2
- P3 Weekly program P3
- Anti-frost mode
- Smart timer

Working model selection

Please note when choosing P1/P2/P3 in the APP, the unit will operate to the settings shown in the manual. If you set P3 manually on the unit and you choose P3 in the APP the unit will operate to the settings you have set. You can also choose to set to your own requirements by selecting the Smart Timer within the App.

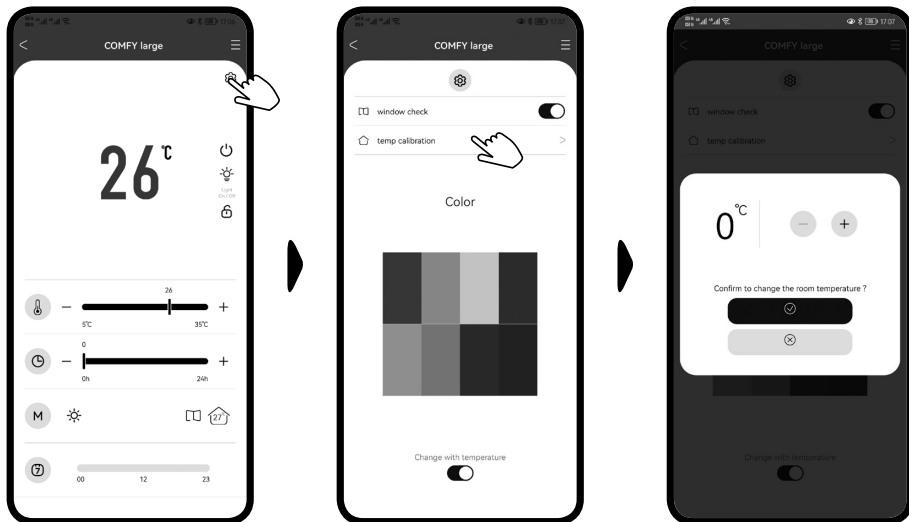
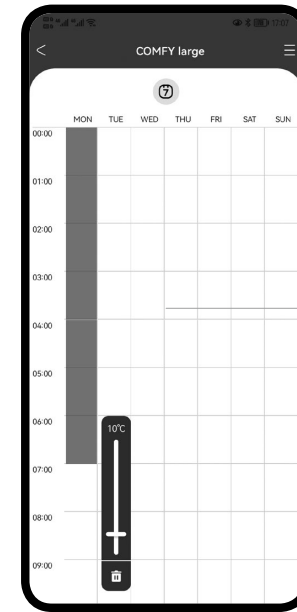
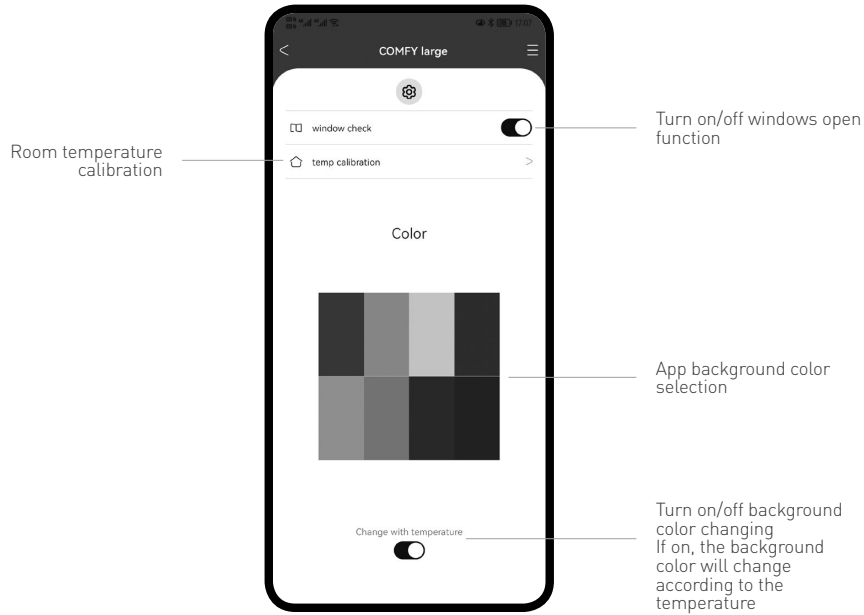

Use this function to set the Room Temperature Calibration to the correct room temperature if it is reading incorrect. Select temp calibration and then adjust temperature to current room temperature and select the tick box. The current room temperature is now set.

MAINTENANCE

1. Always disconnect the appliance and let it completely cool before any maintenance.
2. Use a vacuum cleaner to remove dust on grilles.
3. Clean the outside of the unit with a damp cloth and then dry it with a dry cloth. Never immerse the unit in water, nor let water drip into the unit.

STORING

1. Always disconnect the appliance, let it completely cool and clean it before storing.
2. If you do not use the device for a long period, put back the unit and the instruction manual to the original carton and store in a dry and ventilated place
3. Do not place any heavy items on top of carton during storing as this may damage the appliance.

Information requirements for electric local space heaters

Model identifier(s): MHPH05-10E					
Item	Symbol	Value	Unit	Item	Unit
Heat output				Type of heat input, for electric storage local space heaters only (select one)	
Nominal heat output	P _{nom}	1.0	kW	Manual heat charge control, with integrated thermostat	[no]
Minimum heat output (indicative)	P _{min}	1.0	kW	Manual heat charge control with room and/or outdoor temperature feedback	[no]
Maximum continuous heat output	P _{maxc}	1.0	kW	Electronic heat charge control with room and/or outdoor temperature feedback	[no]
Auxiliary electricity consumption				Fan assisted heat output	
At nominal heat output	eI _{max}	No	kW	Type of heat output/room temperature control (select one)	
At minimum heat output	eI _{min}	No	kW	Single stage heat output and no room temperature control	[no]
In standby mode	eI _{sb}	0.00061	kW	Two or more manual stages, no room temperature control	[no]
Model identifier(s): MHPH05-15E				With mechanic thermostat room temperature control	
Item	Symbol	Value	Unit	With electronic room temperature control	
Heat output				Electronic room temperature control plus day timer	
Nominal heat output	P _{nom}	1.5	kW	Electronic room temperature control plus week timer	
Minimum heat output (indicative)	P _{min}	1.5	kW	Other control options (multiple selections possible)	
Maximum continuous heat output	P _{maxc}	1.5	kW	Room temperature control, with presence detection	[no]
Auxiliary electricity consumption				Room temperature control, with open window detection	[yes]
At nominal heat output	eI _{max}	No	kW	With distance control option (WiFi Option)	[yes]
At minimum heat output	eI _{min}	No	kW	With adaptive start control	[no]
In standby mode	eI _{sb}	0.00061	kW	With working time limitation	[no]
Contact details				With black bulb sensor	
				Hygiene Supplies Direct Limited, Ground floor, Tayson House, Methley Road, Castleford WF10 1PA	

Information requirements for electric local space heaters

Model identifier(s): MHPH05-20E							
Item	Symbol	Value	Unit				
Heat output							
Nominal heat output	P _{nom}	2.0	kW				
Minimum heat output (indicative)	P _{min}	2.0	kW				
Maximum continuous heat output	P _{maxc}	2.0	kW				
Auxiliary electricity consumption							
At nominal heat output	e _{l,max}	No	kW				
At minimum heat output	e _{l,min}	No	kW				
In standby mode	e _{l,sb}	0.00061	kW				
				Type of heat input, for electric storage local space heaters only (select one)			
				Manual heat charge control, with integrated thermostat		[no]	
				Manual heat charge control with room and/or outdoor temperature feedback		[no]	
				Electronic heat charge control with room and/or outdoor temperature feedback		[no]	
				Fan assisted heat output		[no]	
				Type of heat output/room temperature control (select one)			
				Single stage heat output and no room temperature control		[no]	
				Two or more manual stages, no room temperature control		[no]	
				With mechanic thermostat room temperature control		[no]	
				With electronic room temperature control		[no]	
				Electronic room temperature control plus day timer		[no]	
				Electronic room temperature control plus week timer		[yes]	
Other control options (multiple selections possible)							
Room temperature control, with presence detection		[no]					
Room temperature control, with open window detection		[yes]					
With distance control option (WiFi Option)		[yes]					
With adaptive start control		[no]					
With working time limitation		[no]					
With black bulb sensor		[no]					
Contact details	Hygiene Supplies Direct Limited, Ground floor, Tayson House, Methley Road, Castleford WF10 1PA						



This marking indicates that this product should not be disposed with other household wastes throughout the EU. To prevent possible harm to the environment or human health from uncontrolled waste disposal, recycle it responsibly to promote the sustainable reuse of material resources. To return your used device, please use the return and collection systems or contact the retailer where the product was purchased. They can take this product for environmental safe recycling.

The importer retains his right to make changes in appearance and completeness of the item without preliminary notification to the customer.
The item is for indoor use only.
The manufacturer does not assume any liability for any damage caused directly or indirectly by not following this instruction manual, general safety rules, or interference in the construction of the product.

SERVICE WARRANTY

Hygiene Supplies Direct guarantees the product free from defects in materials and workmanship for a period of 1 year from date of purchase. Should this unit be operated under conditions other than those recommended, at voltages other than the voltage indicated on the unit, or any attempts made to service or modify the unit, then the warranty will be rendered void. The product you buy may sometimes differ slightly from illustrations. This warranty is in addition to, and does not affect, your statutory rights. If you have any problems with this product, please call our Help Desk on **0800 091 3171** or email: sales@hygienesuppliesdirect.com

MYLEK®

YESSS Electrical, YESSS House, Normanton, WF6 1TN
declares that the Mylek Heaters are exclusively manufactured
and imported for Hygiene Supplies Direct Ltd.